

# Catalog

ROBOTIC WELDING  
TORCHES

2023

COBOT



**EDR** torches<sup>®</sup>  
Evolution Design Robotics



# ROBOTIC WELDING TORCHES



We are present worldwide

EDRtorches, S.L.  
Calle Miguel Angel Blanco 28. 46138 -  
Rafelbuñol - Valencia Spain.  
www.edrtorches.com  
info@edrtorches.com  
Tel. 0034 963 558 893

## Company

"We understand that the development of a product starts at the design stage but just as important are quality and production"

Companies with technological or industrial character know the importance of innovating to continue in the current market. In EDR torches this becomes a work philosophy, we understand that without innovation it is not possible to advance in such a competitive world where companies and professionals need increasingly complex solutions.



EDR torches has a strong R & D department dedicated to the development of new welding applications, providing customized solutions both in the area of robotic welding and manual.

We understand that the development of a product begins at the design stage but just as important are the quality and production designed and tested.

The long experience of EDR torches in all sectors related to welding makes us capable of providing the best solutions to your manufacturing challenges, tell us what you need and we will make it possible.

## R&D

"EDRtorches is the result of a long engineering work developing products for robotic welding system"

When we gather in a company more than 20 years of experience in designing applications and solutions in welding, with a high level engineering team only something good can arise, EDRtorches is the result of a long engineering work developing products for welding systems robotic, automated and manual.



Our spirit of continuous innovation is evident in the entire product line we manufacture, we believe that we must see beyond what the industry needs and anticipate solutions to future challenges.

With the product ranges endorsed by companies worldwide, we ensure the most appropriate solution to your demand, in addition to a high level of advice.

EDRtorches we have the solution and the product you need.



## Welding torches

Torch MIG/MAG gas 42G 8 Pag.

Torch MIG/MAG liquid 52W 10 Pag.

Torch MIG/MAG liquid 40W (DUAL COOLING) 12 Pag.

Torch TIG liquid T4W 14 Pag.

Torch TIG liquid T5W **NEW** 16 Pag.

Cleaning station CS2 18 Pag.

Control disc CD-2S 22 Pag.

Protection cover 24 Pag.

Accessories 26 Pag.

Technical Annexes 28 Pag.

Range of torches designed welding solutions with collaborative robots. This line of COBOT series torches adapts perfectly to all the requirements of collaborative robots due to its low weight and functionality.

Robust and light necks calibrated to maintain a stable TCP during the life of the torch, in addition to stainless steel structure that gives an excellent rigidity and avoids the increase of the temperature in the back areas of the neck, being able to be handled with greater ease, but always maintaining the precautions that a welding process requires.



Welding torches designed for collaborative robots do not need anti-collision systems, which makes them lighter and easier to set up.

They can be used with control elements to facilitate the programming of the robot with the position 4 disc, but this is not necessary if your application does not require it.



- 1- Torch necks. and -Power cables.
- 2- Adapter flanges
- 3- Discs adapters for robots.
- 4- Accessories torches.





Welding process:  
MIG/MAG, GMAW, 131,135  
Technical data according to IEC60974-7



Gas



300 A - CO2 100%



250 A - Mix M21 (ISO 14175) 100%



Ø1.0-1.2 mm



10-18 l/min

The capacity will be reduced by 35% with pulsed arc.

Line of COBOT torches adapts perfectly to all the requirements of collaborative robots due to its low weight and functionality.

Robust and light necks calibrated to maintain a stable TCP during the life of the torch, in addition to stainless steel structure that gives an excellent rigidity and avoids the increase of the temperature in the back areas of the neck, being able to be handled with greater ease, but always maintaining the precautions that a welding process requires.

STANDARD CONFIGURATION

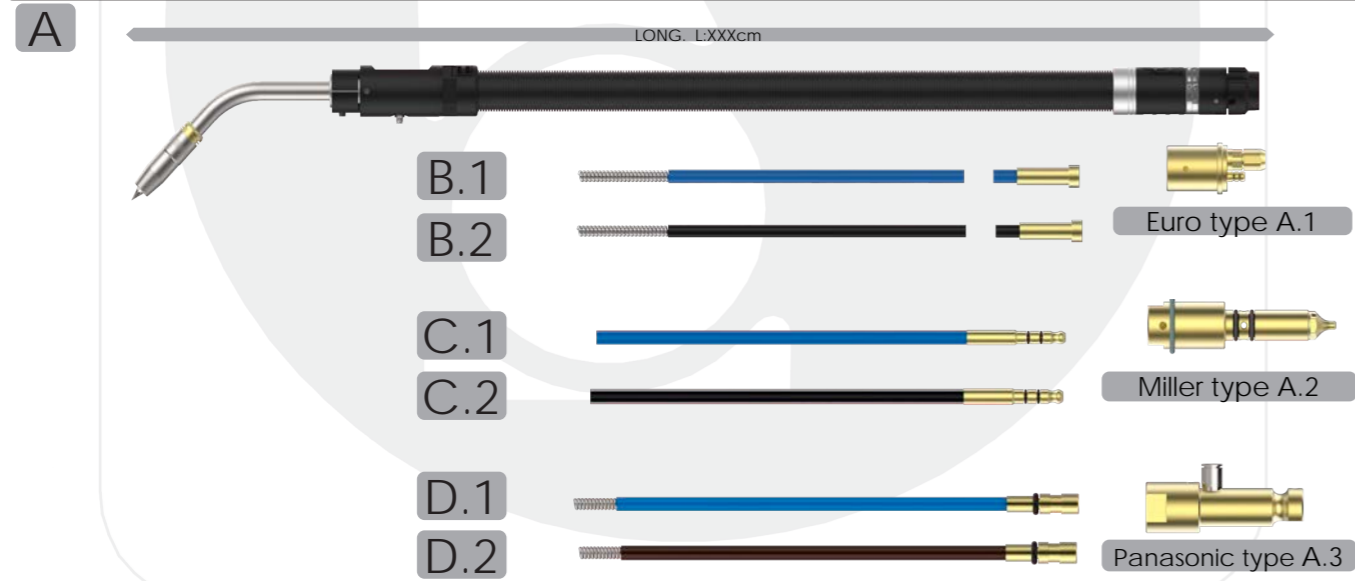

Pos.	TYPE	CODE	Min. Q.
A.1	Welding torch 42G-22° gas eBASIC 4mts-Euro type	R98 1400 22	1
	Welding torch 42G-45° gas eBASIC 4mts-Euro type	R98 1400 45	1
A.2	Welding torch 42G-22° gas eBASIC 4mts-Miller type	R98 2400 22	1
	Welding torch 42G-45° gas eBASIC 4mts-Miller type	R98 2400 45	1
A.3	Welding torch 42G-22° gas eBASIC 4mts-Panasonic type	R98 3400 22	1
	Welding torch 42G-45° gas eBASIC 4mts-Panasonic type	R98 3400 45	1
B.1	Guide blue L3600xØ4.6xØ1.5mm (0.8-1.0mm)-Euro	M99SR03B	1
	Guide blue L4600xØ4.6xØ1.5mm (0.8-1.0mm)-Euro	M99SR04B	1
B.2	Guide black L3600xØ5.3xØ2.2mm (1.2-1.6mm)-Euro-HD	M99 4003	1
	Guide black L4600xØ5.3xØ2.2mm (1.2-1.6mm)-Euro-HD	M99 4004	1
C.1	Guide blue L3600xØ4.6xØ1.5mm (0.8-1.0mm)-Miller type	M99 1003	1
	Guide blue L4600xØ4.6xØ1.5mm (0.8-1.0mm)-Miller type	M99 1004	1
C.2	Guide black L3600xØ5.3xØ2.2mm (1.2-1.6mm)-Miller type	M99 1103	1
	Guide black L4600xØ5.3xØ2.2mm (1.2-1.6mm)-Miller type	M99 1104	1
D.1	Guide blue L3600xØ4.6xØ1.5mm (0.8-1.0mm)-Panasonic type	M99 1303	1
	Guide blue L4600xØ4.6xØ1.5mm (0.8-1.0mm)-Panasonic type	M99 1304	1
D.2	Guide black L3600xØ5.3xØ2.2mm (1.2-1.6mm)-Panasonic type	M99 1203	1
	Guide black L4600xØ5.3xØ2.2mm (1.2-1.6mm)-Panasonic type	M99 1204	1

enDS-42G-02

SPARE PARTS

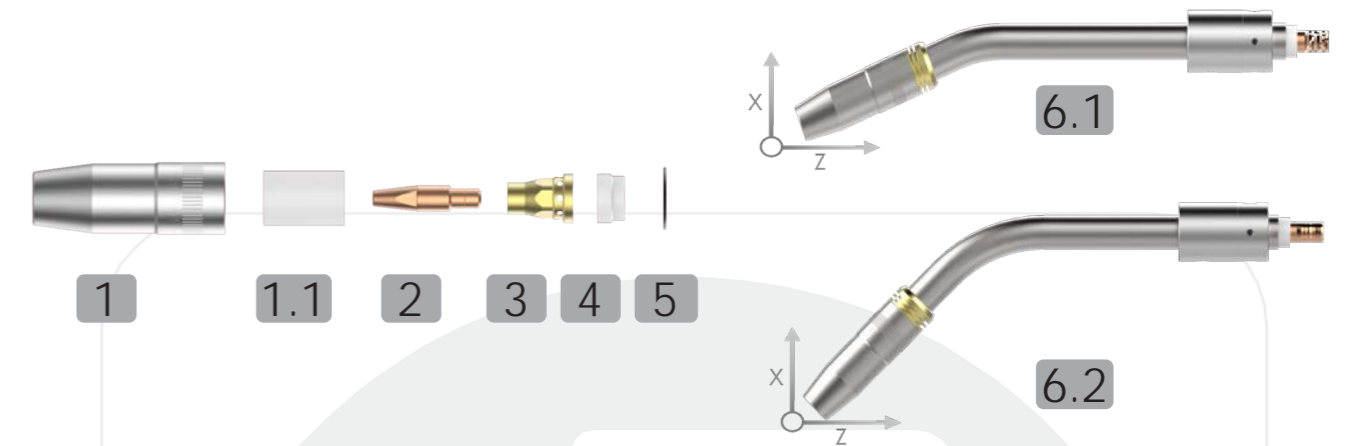

Pos.	TYPE	CODE	Min. Q.
1	Nozzle L76xØ15.5 mm	R10 0011	2
	Nozzle L76xØ13 mm	R10 0012	2
	Nozzle L79xØ15.5 mm	R10 00211	2
1.1	Insulator nozzle L35XØ19.5 mm	R10 0002	2
2	Contact tip M10 1.0 mm Cu-BICOMP	R10 0400 10	5
	Contact tip M10 1.2 mm Cu-BICOMP	R10 0400 12	5
	Contact tip M10 0.8 mm CuCrZr	R10 0401 08	10
	Contact tip M10 1.0 mm CuCrZr	R10 0401 10	10
	Contact tip M10 1.2 mm CuCrZr	R10 0401 12	10
3	Diffuser L26xØ18.5 mm M10	R12 0013	2
4	Insulator neck L11XØ18.5 mm	R12 0308	2
5	Oring neck Ø23 mm	R10 0401	10
6.1	Torch neck BASIC-42G 22° (X=50 mm, Z=263 mm)	R11 4220	1
6.2	Torch neck BASIC-42G 45° (X=111 mm, Z=227 mm)	R11 4450	1

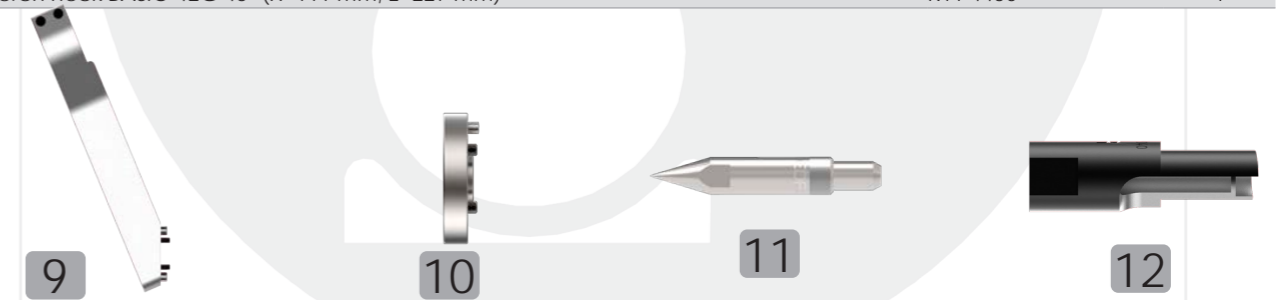

Pos.	TYPE	CODE	Min. Q.
9	Torch bracket eBOT 67°	R41 1023	1
10	Direct adapter disc eBOT D50	R75 0020	1
11	Tip TCP M10-15mm programming	R10 0115	1
12	Clining reamer TH L26xØ15x10.5mm	R03 2040	1

STANDARD MEASURES

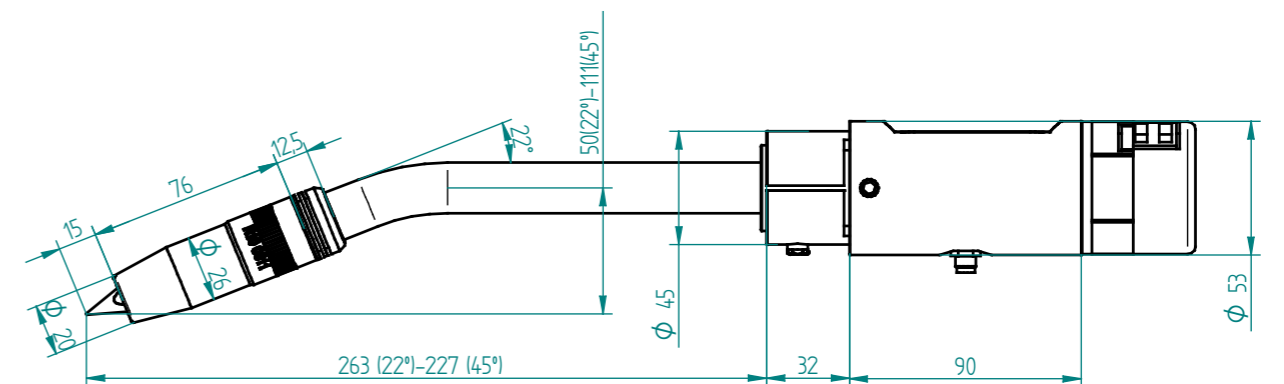



Welding process:  
MIG/MAG, GMAW, 131,135  
Technical data according to IEC60974-7



Liquid



500 A - CO2 100%



400 A - Mix M21 (ISO 14175) 100%



Ø1.0-1.6 mm



10-18 l/min

The capacity will be reduced by 35% with pulsed arc.

Line of COBOT torches adapts perfectly to all the requirements of collaborative robots due to its low weight and functionality.

Robust and light necks calibrated to maintain a stable TCP during the life of the torch, in addition to stainless steel structure that gives an excellent rigidity and avoids the increase of the temperature in the back areas of the neck, being able to be handled with greater ease, but always maintaining the precautions that a welding process requires.

STANDARD CONFIGURATION

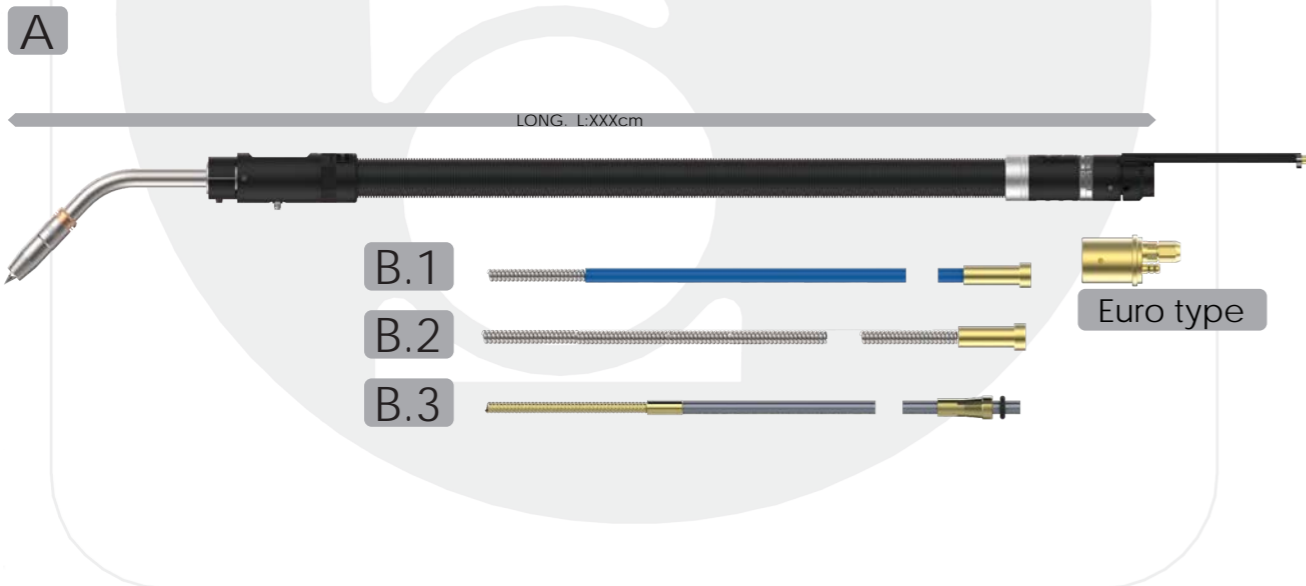

Pos.	TYPE	CODE	Min. Q.
A	Welding torch 52W-22° liquid eBASIC 4mts -Euro type	R99 1400 22	1
	Welding torch 52W-45° liquid eBASIC 4 mts -Euro type	R99 1400 45	1
	Welding torch 52W-0° liquid eBASIC 4 mts-Euro type	R99 1400 00	1
B.1	Guide blue L2600xØ4.6xØ1.5mm (0.8-1.0mm)-Euro	M99SR02B	1
	Guide blue L3600xØ4.6xØ1.5mm (0.8-1.0mm)-Euro	M99SR03B	1
	Guide blue L4600xØ4.6xØ1.5mm (0.8-1.0mm)-Euro	M99SR04B	1
B.2	Guide nude L2600xØ4.6xØ2.2mm (1.2-1.6mm)-Euro-HD	M45SR02	1
	Guide nude L3600xØ4.6xØ2.2mm (1.2-1.6mm)-Euro-HD	M45SR03	1
	Guide nude L4600xØ4.6xØ2.2mm (1.2-1.6mm)-Euro-HD	M45SR04	1
B.3	Guide for Alum L2700xØ4.5xØ2.5mm (1.2-1.6mm)-Euro	M99SA102	1
	Guide for Alum L3700xØ4.5xØ2.5mm (1.2-1.6mm)-Euro	M99SA103	1

enDS-52W-02

SPARE PARTS

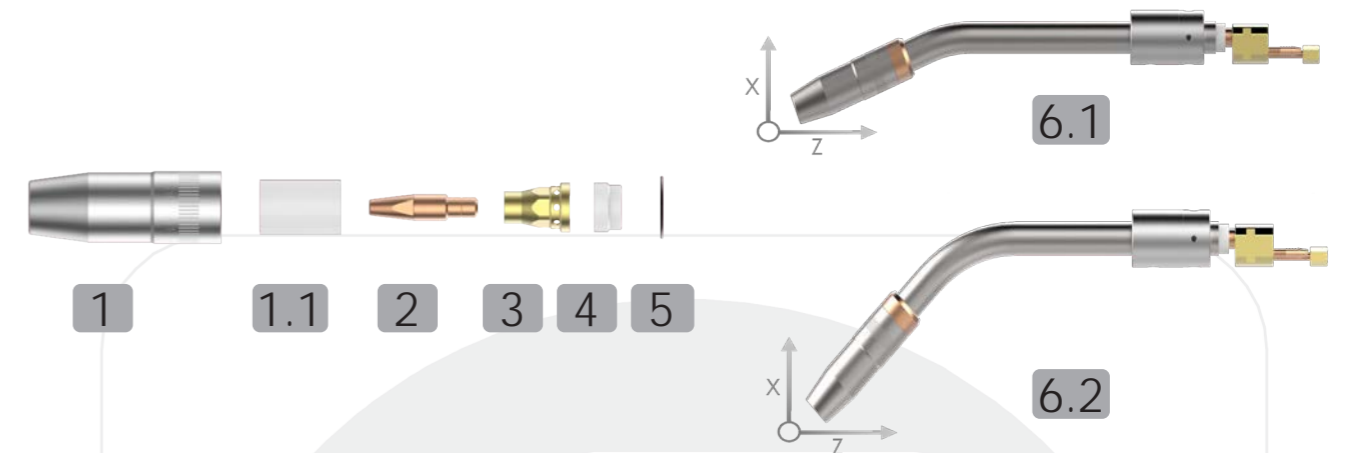

Pos.	TYPE	CODE	Min. Q.
1	Nozzle L76xØ15.5 mm	R10 0011	2
	Nozzle L76xØ13 mm	R10 0012	2
	Nozzle L79xØ15.5 mm	R10 00211	2
1.1	Insulator nozzle L35XØ19.5 mm	R10 0002	2
2	Contact tip M10 1.0 mm Cu-BICOMP	R10 0400 10	5
	Contact tip M10 1.2 mm Cu-BICOMP	R10 0400 12	5
	Contact tip M10 1.6 mm Cu-BICOMP	R10 0400 16	5
	Contact tip M10 0.8 mm CuCrZr	R10 0401 08	10
	Contact tip M10 1.0 mm CuCrZr	R10 0401 10	10
	Contact tip M10 1.2 mm CuCrZr	R10 0401 12	10
	Contact tip M10 1.6 mm CuCrZr	R10 0401 16	10
3	Diffuser L26xØ18.5 mm M10	R12 0013	2
4	Insulator neck L11XØ18.5 mm	R12 0308	2
5	Oring neck Ø23 mm	R10 0401	10
6.1	Torch neck BASIC-52W 22° (X=50 mm, Z=263 mm)	R11 5220	1

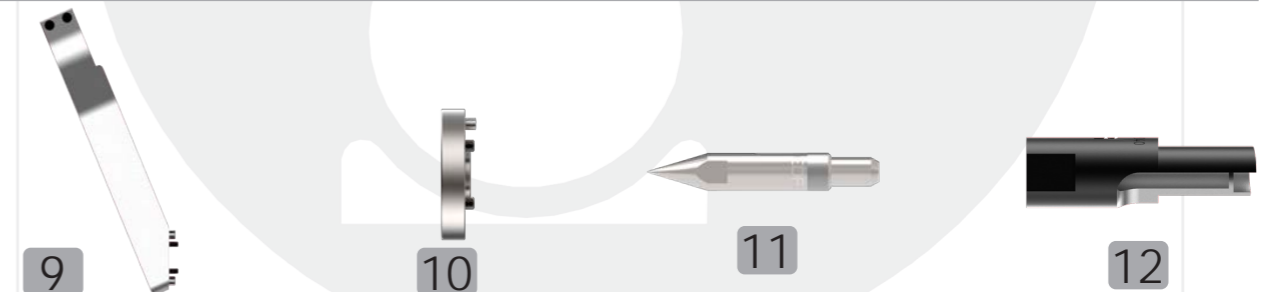

Pos.	TYPE	CODE	Min. Q.
9	Torch bracket eBOT 67°	R41 1023	1
10	Direct adapter disc eBOT D50	R75 0020	1
11	Tip TCP M10-15mm programming	R10 0115	1
12	Clining reamer TH L26xØ15x10.5mm	R03 2040	1

STANDARD MEASURES

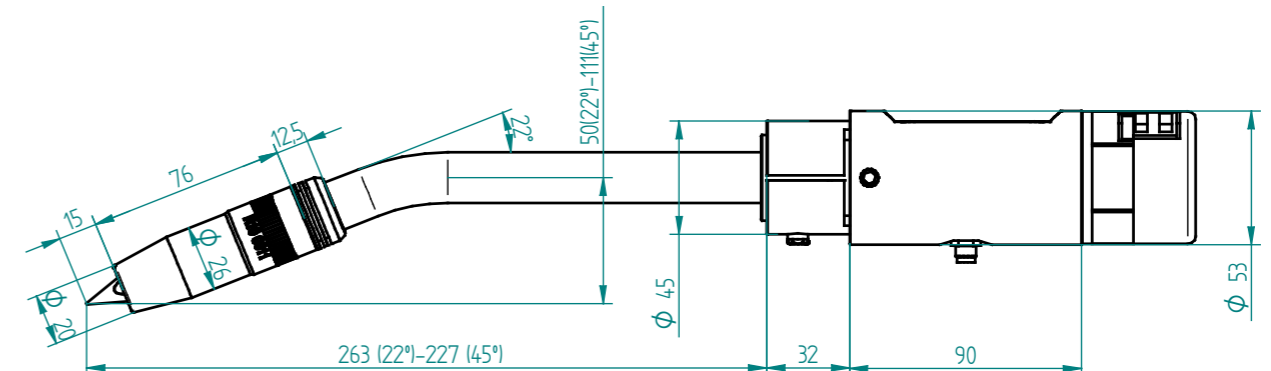



Welding process:  
MIG/MAG, GMAW, 131,135  
Technical data according to IEC60974-7



Liquid



500 A - CO2 100%



400 A - Mix M21 (ISO 14175) 100%



Ø 1.0-1.6 mm



10-18 l/min

The capacity will be reduced by 35% with pulsed arc.

MIG / MAG neck model with high versatility, very versatile for medium-high work intensity and adaptable to a multitude of robotic and automatic applications, one of the most versatile models.

The welding systems for industrial robots BOTseries are designed for work cycles of 24 hours, developed for an intensive use, precise and specifically adapted to long work cycles.

STANDARD CONFIGURATION

A BOT-40W 22° N

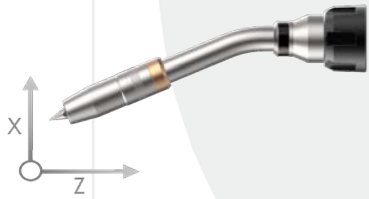

B BOT-40W 22° F N

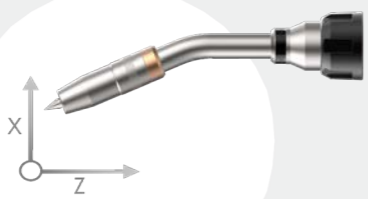

C BOT-40W 45° N



Pos.	TYPE	CODE	Min. Q.
A	Torch neck BOT-40W 22° (X=64 mm, Z=247 mm)-long type N	R14 0220	1
B	Torch neck BOT-40W 22° F (X=50 mm, Z=250 mm)-long type N	R14 0222	1
C	Torch neck BOT-40W 45° (X=111 mm, Z=217 mm)-long type N	R14 0450	1

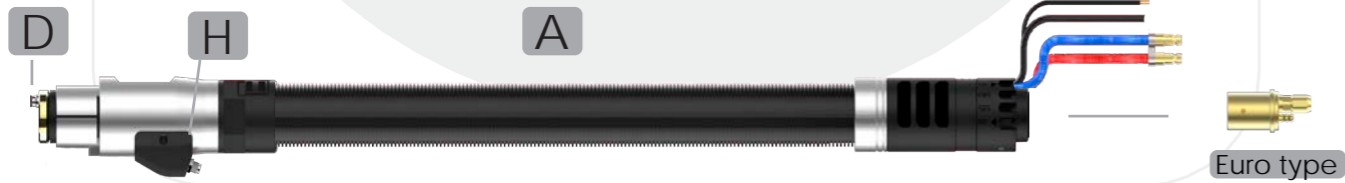

Pos.	TYPE	CODE	Min. Q.
A	Power cable liquid eBOT-Euro type- 2mts	R92 1200	1
	Power cable liquid eBOT-Euro type- 3mts	R92 1300	1
	Power cable liquid eBOT-Euro type-4mts	R92 1400	1
D	Oring power cable gas Ø9	R20 0603	10
H	Connections Box	R30 0003	1
1.1	Guide blue L3600xD4.6xD1.5mm(0.8-1.0)-Euro	M99SR03B	1
	Guide blue L4600xD4.6xD1.5mm(0.8-1.0)-Euro	M99SR04B	1
1.2	Guide black L3600xD5.3xD2.2mm(1.2-1.6)-Euro	M99 4003	1
	Guide black L4600xD5.3xD2.2mm(1.2-1.6)-Euro	M99 4004	1
1.3	Guide for Alum BOT L2700xD4.5xD2.5mm(1.2-1.6)-Euro	M99 7002	1
	Guide for Alum BOT L3700xD4.5xD2.5mm(1.2-1.6)-Euro	M99 7003	1

enDS-BOT40W-02

SPARE PARTS

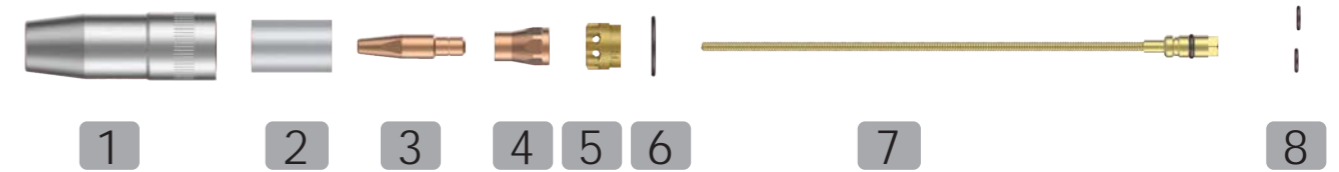

Pos.	TYPE	CODE	Min. Q.
1	Nozzle L76xØ15.5 mm	R10 0011	2
	Nozzle L76xØ13 mm	R10 0012	2
	Nozzle L79xØ15.5 mm	R10 0211	2
2	Insulator nozzle L35XØ19.5 mm	R10 0002	2
3	Contact tip M10 1.0 mm Cu-BICOMP	R10 0400 10	5
	Contact tip M10 1.2 mm Cu-BICOMP	R10 0400 12	5
	Contact tip M10 1.6 mm Cu-BICOMP	R10 0400 16	5
	Contact tip M10 1.2 mm Cu-BICOMP Alum	R10 0400 12A	5
	Contact tip M10 1.6 mm Cu-BICOMP Alum	R10 0400 16A	5
	Contact tip M10 0.8 mm CuCrZr	R10 0401 08	10
	Contact tip M10 1.0 mm CuCrZr	R10 0401 10	10
	Contact tip M10 1.2 mm CuCrZr	R10 0401 12	10
	Contact tip M10 1.6 mm CuCrZr	R10 0401 16	10
4	Tip holder L22xØ15 mm M10	R10 0013	2
5	Diffuser Insulator neck L14XØ18.5 mm	R12 0404	2
6	Oring neck Ø23 mm	R10 0401	10
7	Liner for neck type N 217mm	R10 1112	1
8	Oring neck water Ø9 mm	R12 0008	10



Pos.	TYPE	CODE	Min. Q.
9	Torch bracket eBOT 67°	R41 1023	1
10	Direct adapter disc eBOT D50	R75 0020	1
11	Tip TCP M10-15mm programming	R10 0115	1
12	Clining reamer TH L26xØ15x10.5mm	R03 2040	1
13	Neck tool BOT	R04 0000	1

STANDARD MEASURES

DATA	
Weight (kg)	2.10
TCP mm (tool center point)	Y:12.5, Z:333
GC mm (gravity center)	Y:121.6 / Z:122.5

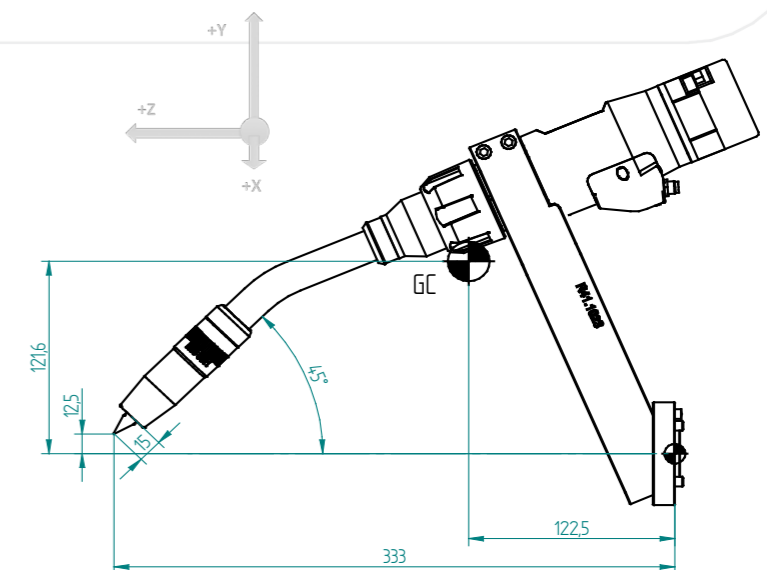



Welding process:  
TIG, GTAW, 141  
Technical data according to IEC60974-7



- Liquid
- 400 A - CD 100%
- 300 A - AC 100%
- Ø 1.6-4.0 mm
- 4-12 l/min

The capacity will be reduced by 35% with pulsed arc.

Line of COBOT torches adapts perfectly to all the requirements of collaborative robots due to its low weight and functionality.

STANDARD CONFIGURATION

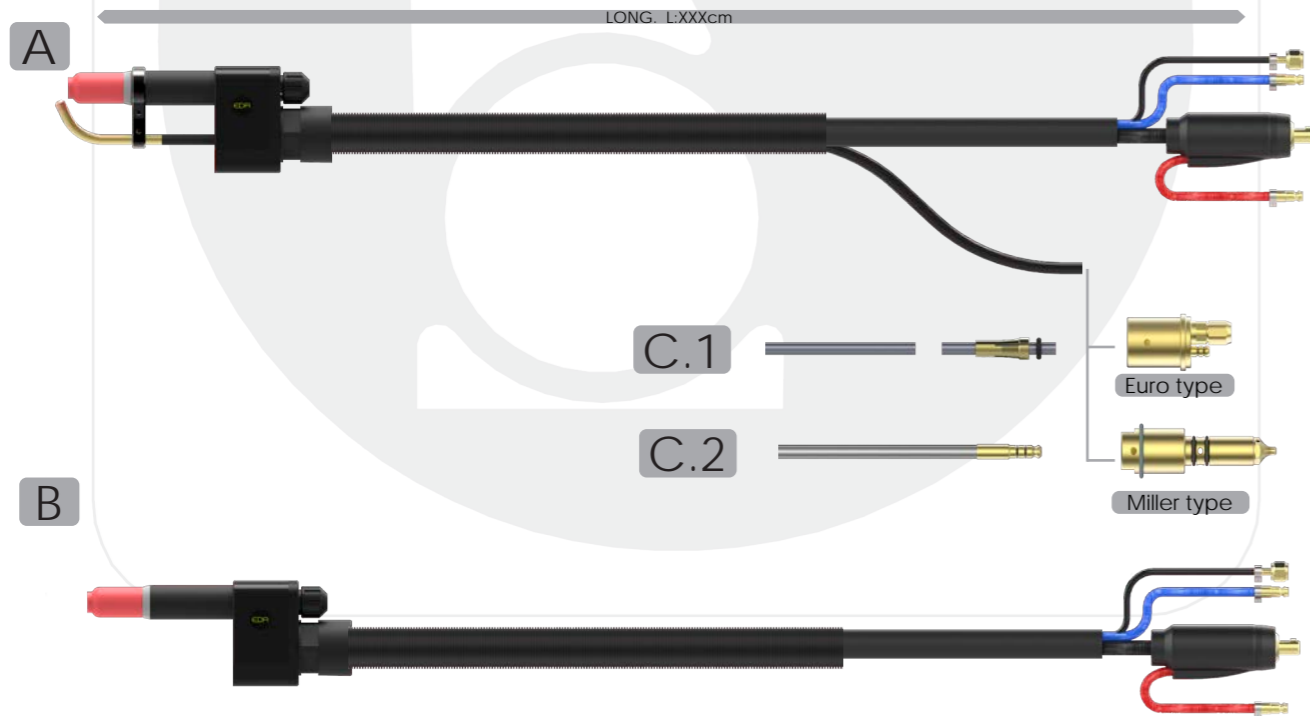

Pos.	TYPE	CODE	Min. Q.
A	Welding torch TIG T4W liquid BASIC - 35/50-GCOLD WIRE Euro type	R99 8xxx E	1
	Welding torch TIG T4W liquid BASIC - COLD WIRE Miller type	R99 8xxx M	
B	Welding torch TIG T4W liquid BASIC	R99 8xxx	1
C.1	Guide TEFLON itBOT L2700xD4xD2mm(1.0-1.2)-Euro	M99 8002	1
	Guide TEFLON itBOT L3700xD4xD2mm(1.0-1.2)-Euro	M99 8003	1
C.2	Guide TEFLON itBOT L2700xD4xD2mm(1.0-1.2)-Miller	M99 1502	1
	Guide TEFLON itBOT L3700xD4xD2mm(1.0-1.2)-Miller	M99 1503	1

enDS-T4W-02

SPARE PARTS

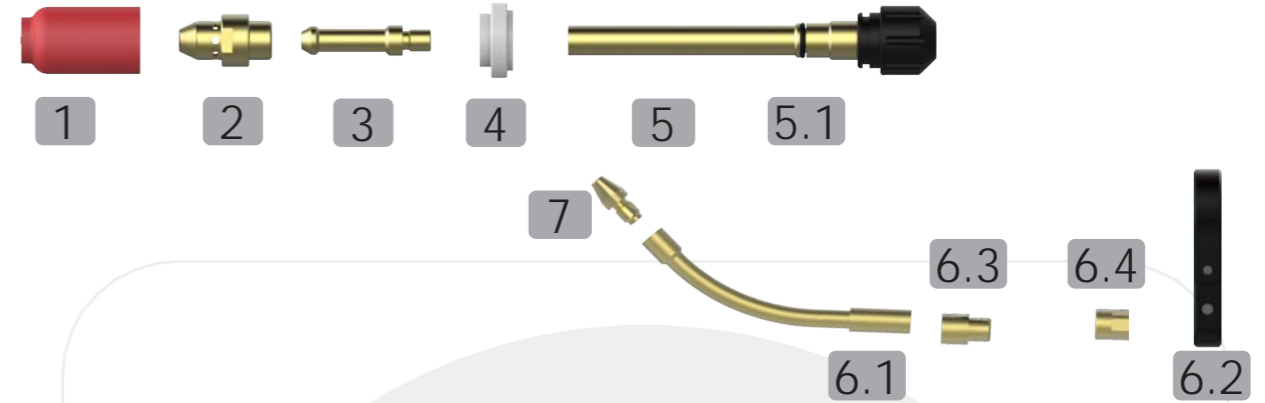

Pos.	TYPE	CODE	Min. Q.
1	Nozzle G6	T54N16	10
	Nozzle G7	T54N15	10
	Nozzle G8	T54N14	10
2	Diffuser M14 2.4mm	R15 5304	2
	Diffuser M14 3.2mm	R15 5305	2
3	Electrode holder 2.4 mm	R15 5524	2
	Electrode holder 3.2 mm	R15 5532	2
4	Insulator Nozzle	R15 5303	2
5	Clamping element	R15 5502	1
5.1	Oring clamping element	R15 0502	5
6.1	Wire guide	R15 0021	1
6.2	Support wire guide	R15 0022	1
6.3	Support liner	R15 0024	1
6.4	Liner fixing nut	M99MZ02	1
7	Tip Dia. 1.0 mm	R15 0110	5
	Tip Dia. 1.2 mm	R15 0112	5



Pos.	TYPE	CODE	Min. Q.
8	Bracket TIG T4W 30°	R41 4001	1
9	Direct adapter disc insulator D50	R75 0021	1

STANDARD MEASURES

DATA	
Weight (kg)	1.060 kg
TCP mm (tool center point)	Y:50, Z:246
GC mm (gravity center)	Y:78 / Z:109

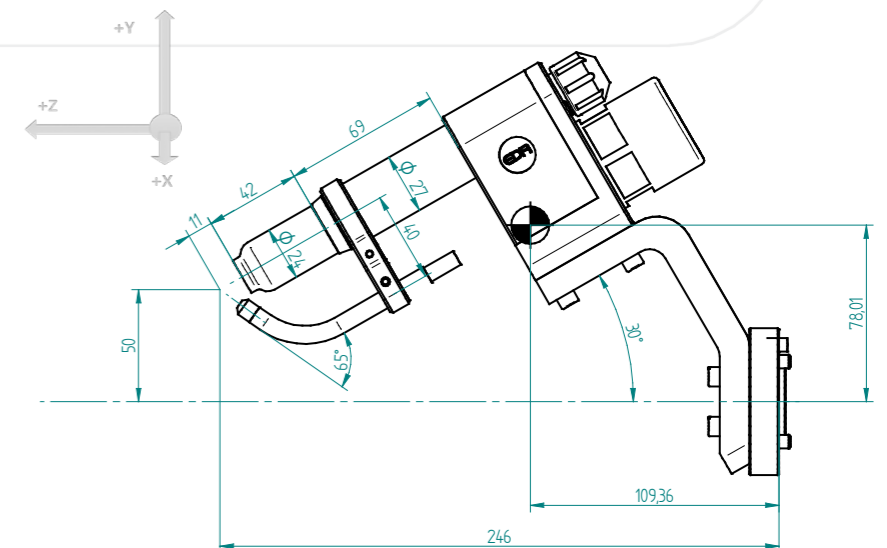



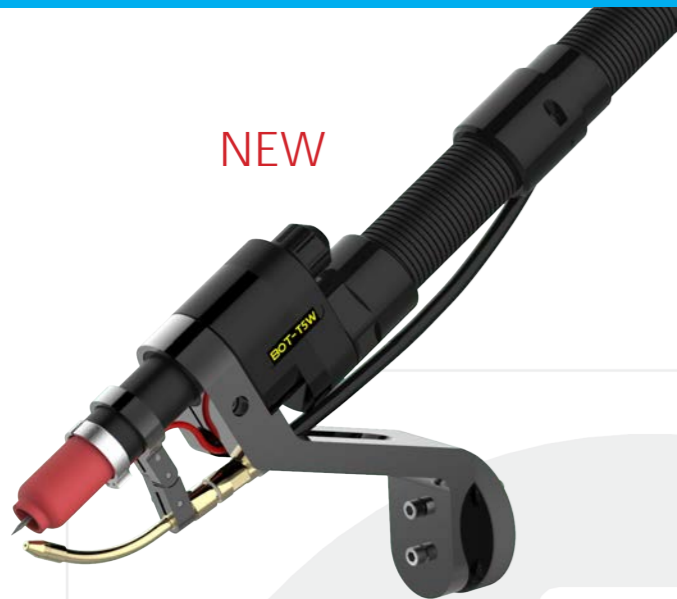

**Welding process:**  
TIG, GTAW, 141  
Technical data according to IEC60974-7

**CE**

- Liquid
- 400 A - CD 100%
- 300 A - AC 100%
- Ø 1.6-4.0 mm
- 4-12 l/min

The capacity will be reduced by 35% with pulsed arc.

Line of COBOT torches adapts perfectly to all the requirements of collaborative robots due to its low weight and functionality. This model has the capacity to connect an anti-collision system and adjustment of the position angle of the wire

STANDARD CONFIGURATION

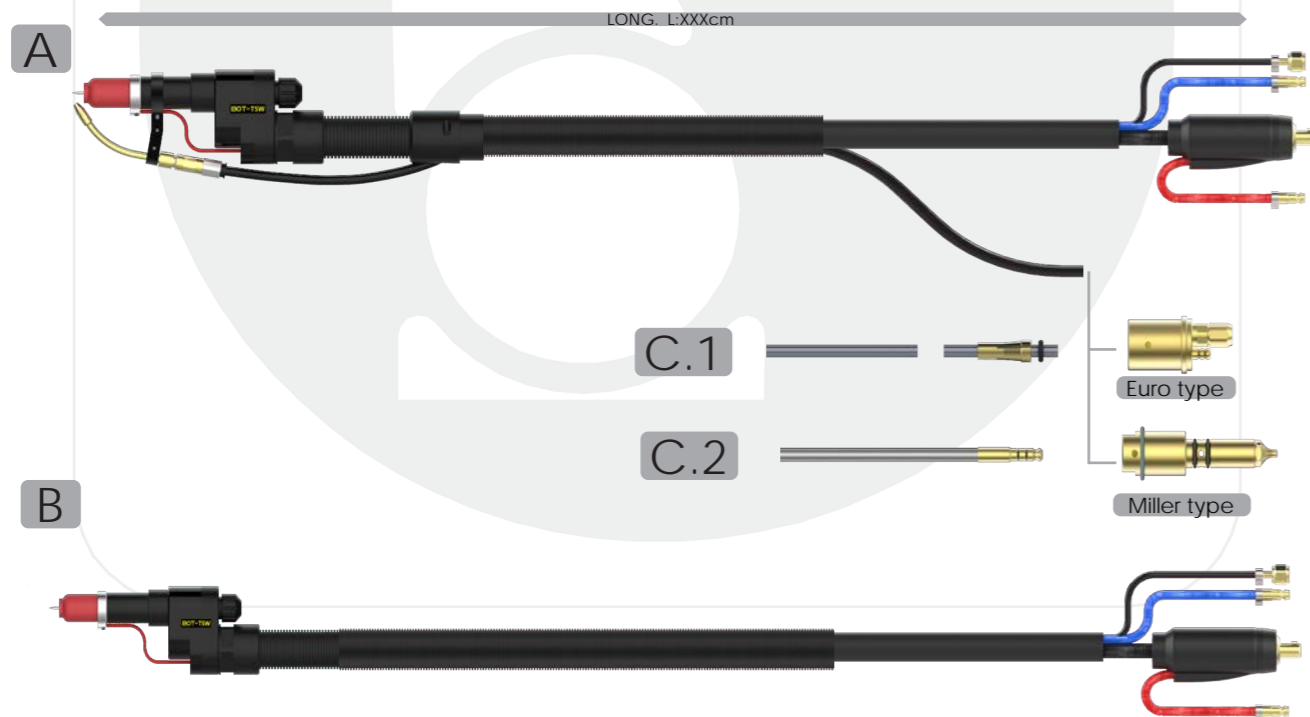

Pos.	TYPE	CODE	Min. Q.
A	Welding torch TIG T5W - COLD WIRE Euro type	R97 8xxx E	1
	Welding torch TIG T5W - COLD WIRE Miller type	R97 8xxx M	
B	Welding torch TIG T5W	R97 8xxx	1
C.1	Guide TEFLON itBOT L2700xD4xD2mm(1.0-1.2)-Euro	M99 8002	1
	Guide TEFLON itBOT L3700xD4xD2mm(1.0-1.2)-Euro	M99 8003	1
C.2	Guide TEFLON itBOT L2700xD4xD2mm(1.0-1.2)-Miller	M99 1502	1
	Guide TEFLON itBOT L3700xD4xD2mm(1.0-1.2)-Miller	M99 1503	1

enDS-T5W-00

SPARE PARTS

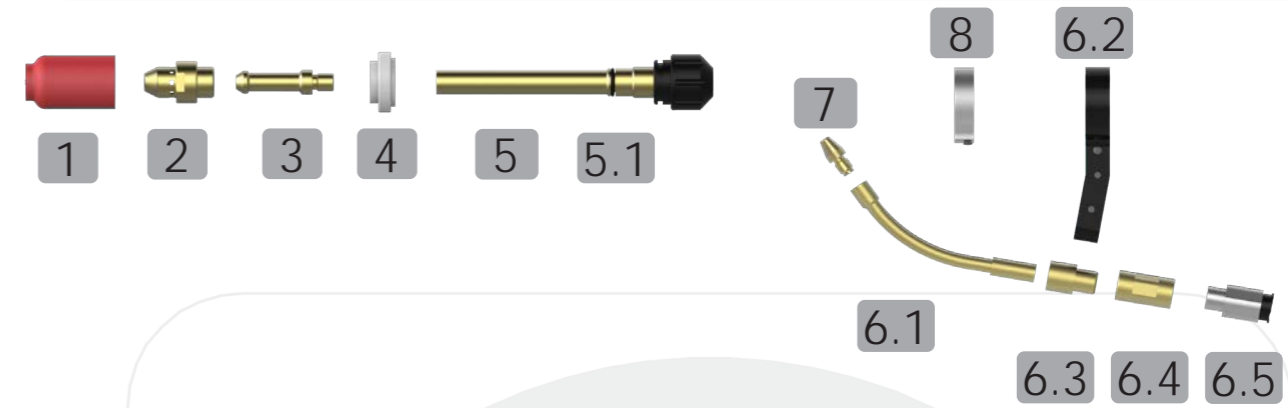

Pos.	TYPE	CODE	Min. Q.
1	Nozzle G6	T54N16	10
	Nozzle G7	T54N15	10
	Nozzle G8	T54N14	10
2	Diffuser M14 2.4mm	R15 5304	2
	Diffuser M14 3.2mm	R15 5305	2
3	Electrode holder 2.4 mm	R15 5524	2
	Electrode holder 3.2 mm	R15 5532	2
4	Insulator Nozzle	R15 5303	2
5	Clamping element	R15 5502	1
5.1	Oring clamping element	R15 0502	5
6.1	Wire guide	R15 0021	1
6.2	Support wire guide	R15 0301	1
6.3	Support liner	R15 0024	1
6.4	Liner Fixing nut support	R15 0026	1
6.5	Tube fitting D8	R15 0027	1
7	Tip Dia. 1.0 mm	R15 0110	5
	Tip Dia. 1.2 mm	R15 0112	5
8	HF protective ring	R15 0603	1

Pos.	TYPE	CODE	Min. Q.
8	Bracket TIG T5W 30°	R41 5001	1
9	Direct adapter disc insulator D50	R75 0021	1

MEASURES

DATA	
Weight (kg)	1.320 kg
TCP mm (tool center point)	Y:50, Z:246
GC mm (gravity center)	Y:61 / Z:73

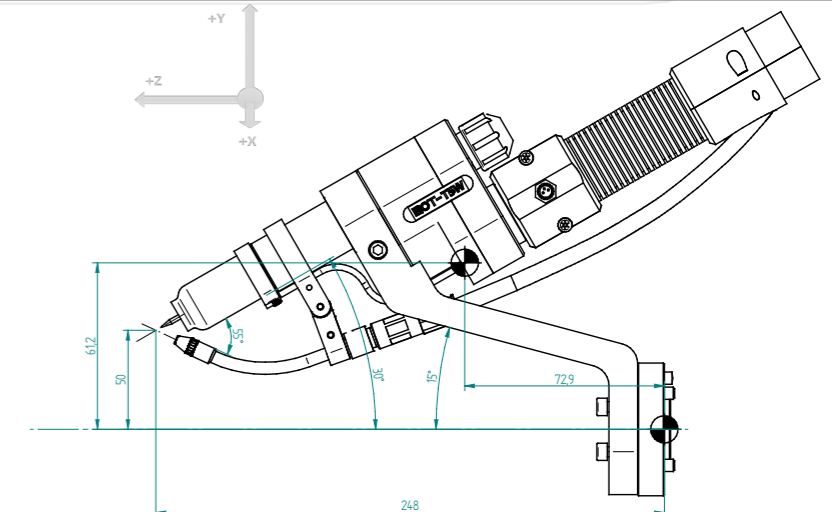



Welding process:  
MIG/MAG,

- 6-8 bar \*
- +5 - +50C°
- Min flow 10 l/s
- 6.3 Nm - 425 rpm
- 0.5 l spatter
- Max. 1.6 mm (solid wire)
- Max. 3.2 mm (tubular wire)
- Time cut 0.5 seg

(\*) Oil-free compressed air

Nozzle cleaning station for automated and robotized welding torches. It incorporates welding wire cutting unit. Guarantees continuity of the welding process, keeping the nozzle of the welding torch free of slag and projections

Main advantages:

- Elimination of cycle interruptions due to accumulation of projections.
- Notable improvement of the initial priming efficiency while maintaining an optimum wire length
- Cleaning efficiency, short cycle time.
- Total elimination of embedded projections
- Includes TCP programming verification point

Choose your reamer BOT series

BOT 30G 42G	Nozzle L76xD13mm	Nozzle L76xD15.5mm	Nozzle L79xD15.5mm
	R03 2041	R03 2040	R03 2061
BOT 31W	Nozzle L47xD13.5mm		
	R03 2030		
BOT 40W 52W	Nozzle L76xD13mm	Nozzle L76xD15.5mm	Nozzle L79xD15.5mm
	R03 2041	R03 2040	R03 2042
BOT 41EC	Nozzle L76xD15.5mm		
	R03 2010		
BOT 50W	Nozzle L60xD15.5mm	Nozzle L60xD18mm	
	R03 2040	R03 2050	
BOT 60W	Nozzle L16xD15.5mm	Nozzle L16xD18mm	Nozzle L16xD21mm
	R03 2061	R03 2060	R03 2062



A

Pos.	TYPE	CODE	Min. Q.
A	Clean station with wire cut (complete)	R02 2001	1

Reamer types for BOT series

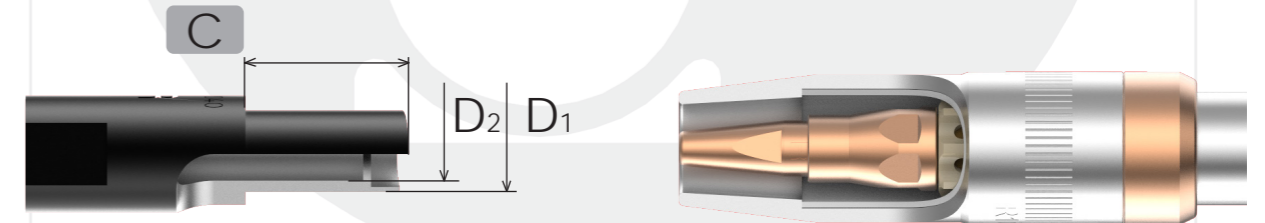

Pos.	TYPE	CODE	Min. Q.
C	Cleaning reamer TH L23xD13xD8.5 mm	R03 2030	1
	Cleaning reamer EC TH L38.5xD15xD10.5 mm	R03 2010	1
	Cleaning reamer TH L26xD15xD10.5 mm	R03 2040	1
	Cleaning reamer TH L22xD12.5xD10.5 mm	R03 2041	1
	Cleaning reamer TH L26xD17.5xD10.5 mm	R03 2050	1
	Cleaning reamer TH L29xD17.5xD10.5 mm	R03 2060	bp
	Cleaning reamer TH L29xD15xD10.5 mm	R03 2061	bp
	Cleaning reamer TH L29xD20.5xD10.5 mm	R03 2062	bp

bp: product out of stock, manufacture on demand

Spare parts

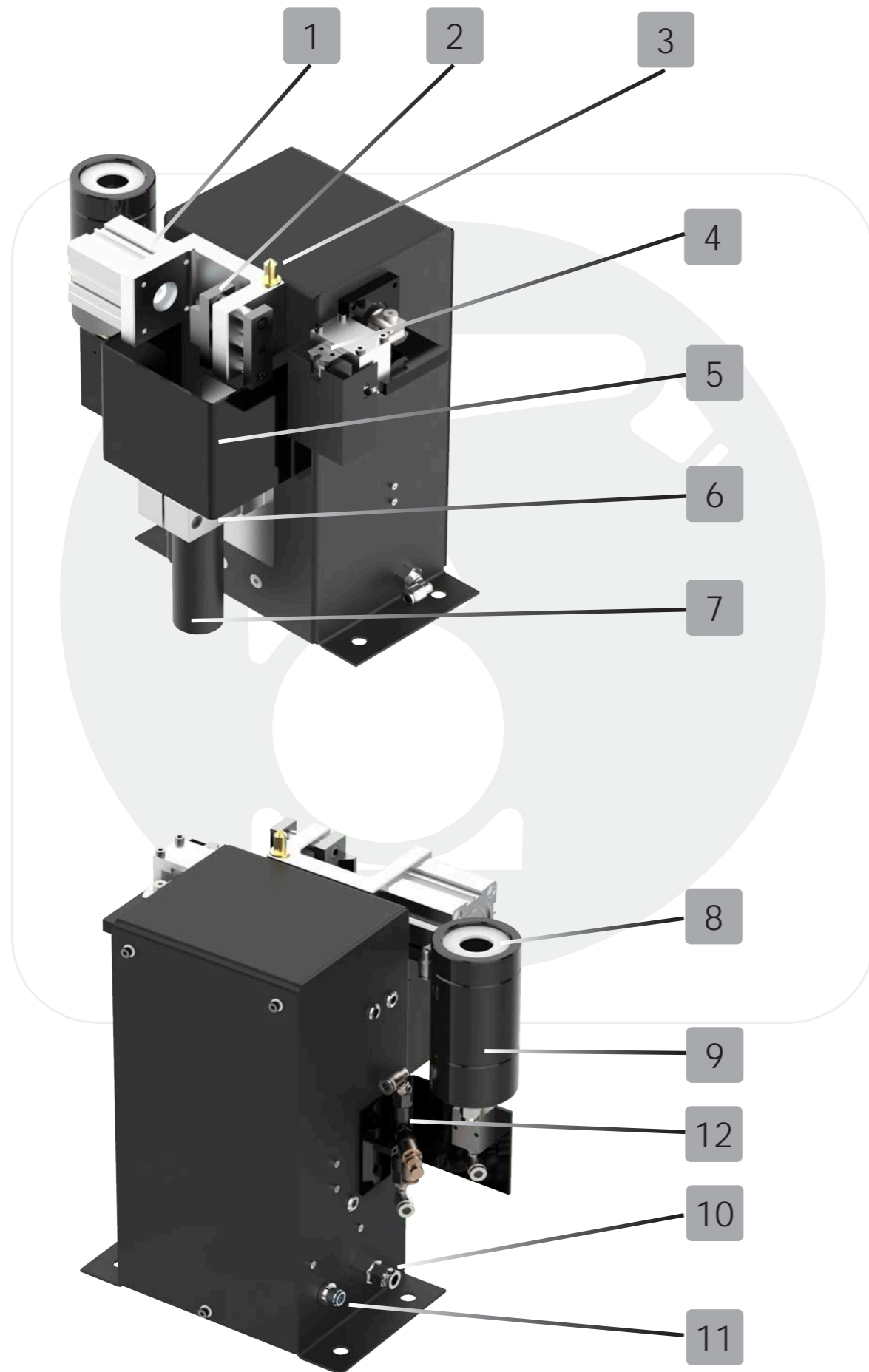

Pos.	Parts name	Functional descriptions	CODE	Min. Q.
1	Clamping cylinder	Automatic clamping welding nozzle	R02 2P01	1
2	Locator block	Fixing welding gun sprayer nozzle	R02 2P02	1
3	TCP positioning pin	TCP positioning points	R02 2P03	1
4	Wire shearing device	Wiping out needless welding wire	R02 2P04	1
5	Reamer protective cover	Preventing ejection of splash	R02 2P05	1
6	Motor mounting base	Adjusting height of pneumatic motor	R02 2P06	1
7	pneumatic motor	Driving reamer for cleaning	R02 2P07	1
8	Spray protector	Protect losses of liquid spray	R02 2P08	1
9	Anti-sling Unit	Spraying anti-sling agent	R02 2P09	1
10	Air connection port	Connecting 8mm air pipe	R02 2P10	1
11	8-pin Aviation plug	Controlling interface by robot	R02 2P11	1
12	Pneumatic distributor	Liquid control anti spatter	R02 2P12	1

Standard reamer types

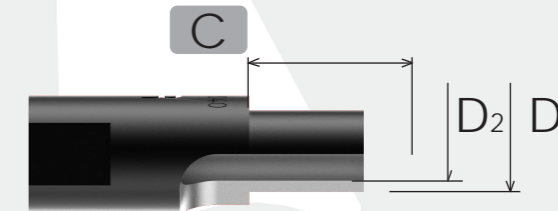

Nozzle Innerdiameter mm	Nozzle Innerdiameter mm	D1 mm	D2 mm	Code.	Min. Q.
10	6	9	7	R03 0907-40	bp
11	6	10	7	R03 1007-40	bp
12	6	11	7	R03 1107-40	bp
13	6	12	7	R03 1207-40	bp
13	8	12	9	R03 1209-40	bp
14	8	13	9	R03 1309-40	bp
15	8	14	9	R03 1409-40	bp
16	8	15	9	R03 1509-40	bp
13	9	12	10	R03 1210-40	bp
14	9	13	10	R03 1310-40	bp
15	9	14	10	R03 1410-40	bp
16	9	15	10	R03 1510-40	bp
15	10	14	11	R03 1411-40	bp
16	10	15	11	R03 1511-40	bp
17	10	16	11	R03 1611-40	bp
18	10	17	11	R03 1711-40	bp
18	12	17	13	R03 1713-40	bp
19	12	18	13	R03 1813-40	bp
20	12	19	13	R03 1913-40	bp

bp: product out of stock, manufacture on demand



Product in collaboration with



- Free-drive control and waypoint recording.
- 440 gr - L42.5 x Ø94 mm

**COMPATIBLE ROBOTS**

Universal Robots UR3, UR5, UR10, UR3e, UR5e, UR10e

**COMPATIBLE CONTROLLERS (others consult)**

Universal Robots CB3.0, CB3.1, e-Series

**COMPATIBLE SOFTWARE (others consult)**

SW 3.6.1, SW 3.8.0, SW 5.0.3



**GENERAL CHARACTERISTICS**

**Description:**  
Control disc for the wrist of UR collaborative robot. Two illuminated push-buttons allow free-drive control and waypoint recording in an easy and comfortable way. These push-buttons can also be used as inputs for the user program. It includes URCap to be installed in the robot controller.

**Usage:**  
As accessory for Universal Robots collaborative robots.

**Main advantages:**

- Ergonomic. Designed for a comfortable use in the robot wrist.
- Light and strong. Machined aluminium body.
- Stylish design. Black anodized surface finished.
- Easy installation with four through-bolts. (Not included.)
- Two multi-function push-buttons with LED light.
- Easy to press buttons: Can be used with globes.

**Functions with program stopped.**

- Free-drive control. To adjust robot's pose with one hand.
- Waypoint recording. To add waypoints to the program.
- LEDs. Each button lights when its function is available.

**Functions with program running.**

- Programmable buttons. Continuation after pause, script launching, conditional programming, etc.
- Programmable LEDs. Script to configure mode and blink.

enDS-DICSUR-CD-2S-02

SPARE PARTS



Pos.	TYPE	CODE	Min. Q.
1	CONTROL DISC CD-2S (includes code R7 3005 02)	R78 000C	1
2.1	DISC SCREW M6x50 mm DIN7991(For standard disc)	R7 3005 02	1
	DISC SCREW M6x50 mm DIN912 (For long adapter disc, code R75 0030)	R7 3005 03	1

STANDARD MEASURES

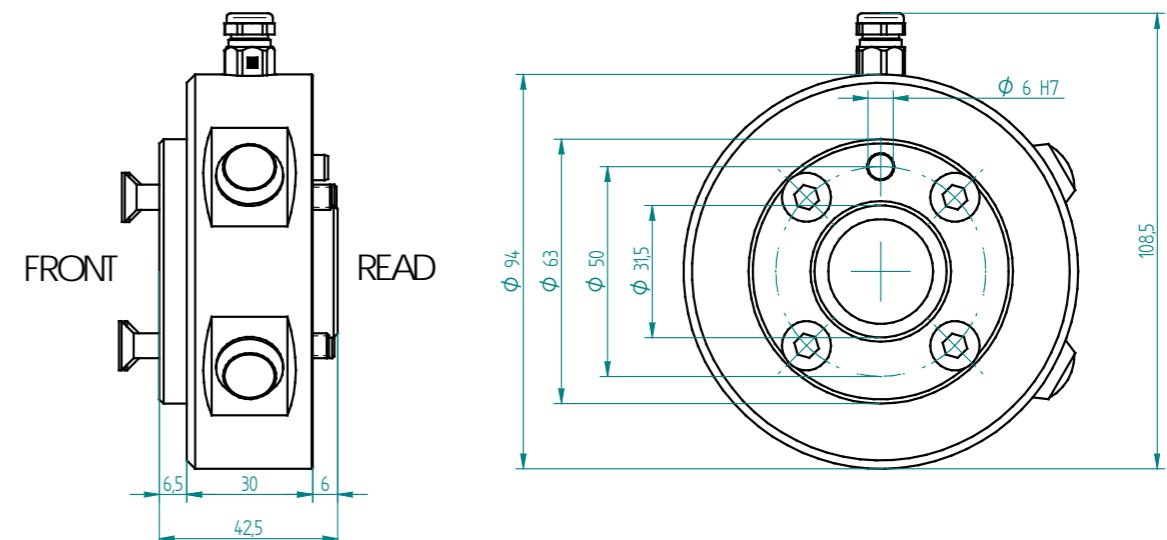



Product in collaboration with



 Fire protection cover for Universal Robots collaborative robots

CODE	ROBOT
R06 1016	- UR 5 CB Series
R06 1013	- UR 5 e-Series
R06 1001	- UR 10 CB Series
R06 1012	- UR 10 e-Series

GENERAL CHARACTERISTICS

**Description:**

Protective cover for collaborative robots of the Universal Robots brand. Protection against typical incandescent welding splashes or environments where emery saw is being used. Protection against thermal radiation and UVA radiation ..

**Use:**

Industrial use in UR collaborative robots used in welding or in environments where hostile temperature conditions or process sparks exist

**Main Advantages:**

- Very low weight.
- Dimensions fully adjusted to the robot.
- Easy placement thanks to its velcro closures.
- Polyester inner lining. Anti-wear to friction.
- UV resistant.
- Resistant to high temperatures, 550°C in intermittent and 150°C in continuous.
- Resistant to welding splashes and flying sparks.

enDS-COVER UR

DATA



Flame retardant protection case consisting of 6 totally independent parts with each other. Made with Fortaglas® Aluminized, (\*) fabric made of fiberglass filaments and textured, with a very thin sheet of aluminum. 100% polyester inner lining.

(\*) Basic woven properties of Robot Case (TVL 119)  
Fortaglas® Aluminizado are fabrics made of fiberglass and textured filaments, with a very thin sheet of aluminum incorporated on 1 side. For protection applications against radiant heat.

Fortaglas® meets the requirements of the most stringent English, European and international standards for flammability applications: BS476 part 7: 1987 Class 1 and BS476 part 6: 1989 Class 0

<b>Weight</b>	gr/m <sup>2</sup>	300 ±10%
<b>Thickness</b>	mm	0.2 ±0.1
<b>Fiberglass diam.</b>	micra/micron	6-9
<b>Weave</b>		satín
<b>Ends-picks 10cm- * Urdimbre / warp</b>		170
<b>* Weft</b>		125
<b>Strength warp</b>	N/50mm	1300
<b>Strength weft</b>	N/50mm	1800
<b>Service temperature</b>		
<b>* Short periods °C</b>	°C	550
<b>* Continuous</b>	°C	150

# Accessories

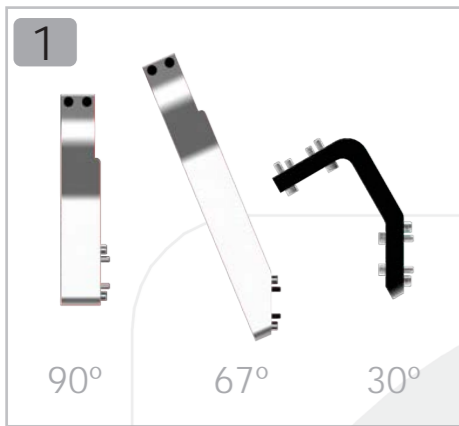

Pos.	TYPE	CODE	Min. Q.
1	Torch bracket eBOT 90°	R41 1000	1
	Torch bracket eBOT 67°	R41 1023	1
	Bracket TIG T4W 30°	R41 4001	1
	Bracket TIG T5W 30°	R41 5001	1

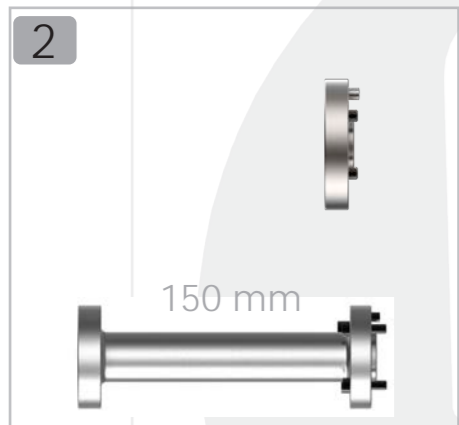

2	Direct adapter disc eBOT D50	R75 0020	1
	Direct adapter disc insulator eBOT D50	R75 0021	1
	Direct adapter disc eBOT D50- Long.150mm	R75 0030	1



3	Fireproof protection cover for UR 5 CB Series	R06 1016	1
	Fireproof protection cover for UR 5 e-Series	R06 1013	1
	Fireproof protection cover for UR 10 CB Series	R06 1001	1
	Fireproof protection cover for UR 10 e-Series	R06 1012	1



4	Control disc UniBOT D50	R78 000C	1
---	-------------------------	----------	---



Pos.	TYPE	CODE	Min. Q.
5	Cleaning station with wire cut (complete)	R02 2001	1
	Anti-projection liquid SPATTER FREE 5 (5l)	R07 1005	1

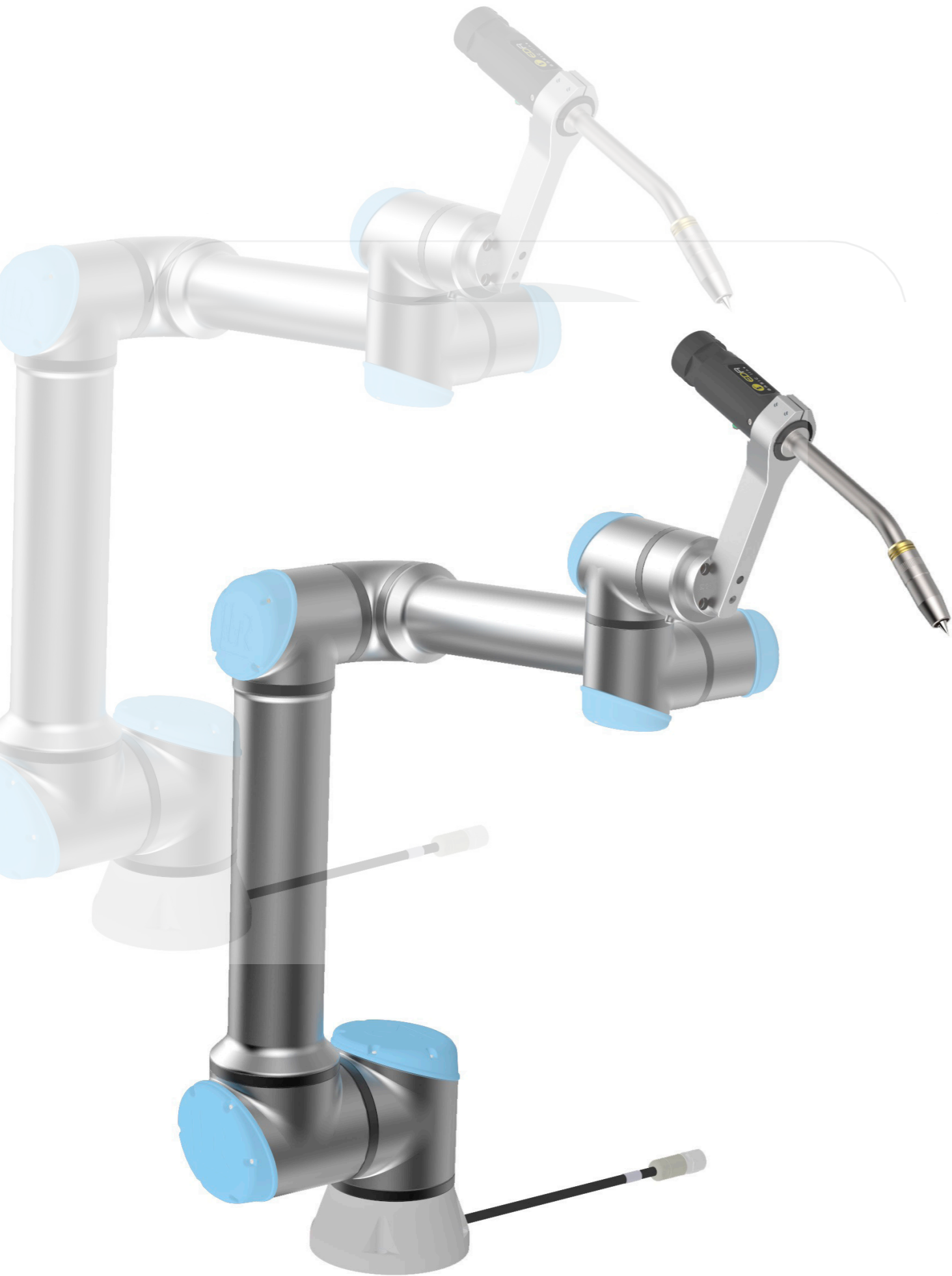

# A

Tehcnical Annexes

Tehcnical Annexes

Installation codes 52W and some configurations

30 Pag.

Installation codes BOT 40W and some configurations

34 Pag.

Installation codes BOT 40W and some configurations

34 Pag.



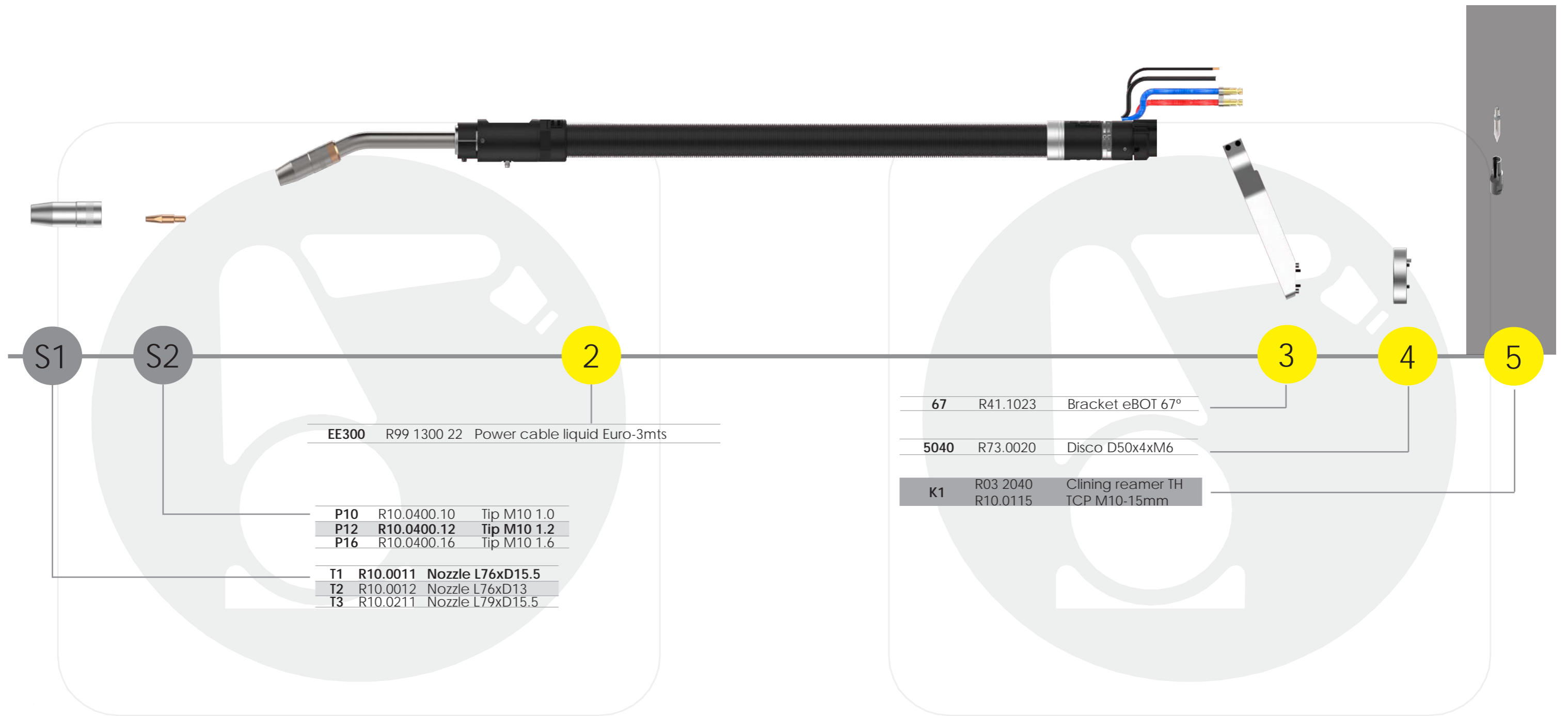

Installation code: T1-P10-EE300-67-5040-K1



# 52W series MIG/MAG



**Welding process:**  
MIG/MAG, GMAW, 131,135

Technical data according to IEC60974-7

- Liquid
- 500 A - CO2 100%
- 400 A - Mix M21 (ISO 14175) 100%

The capacity will be reduced by 35% with pulsed arc.



## CONFIGURATIONS

### BAT5W

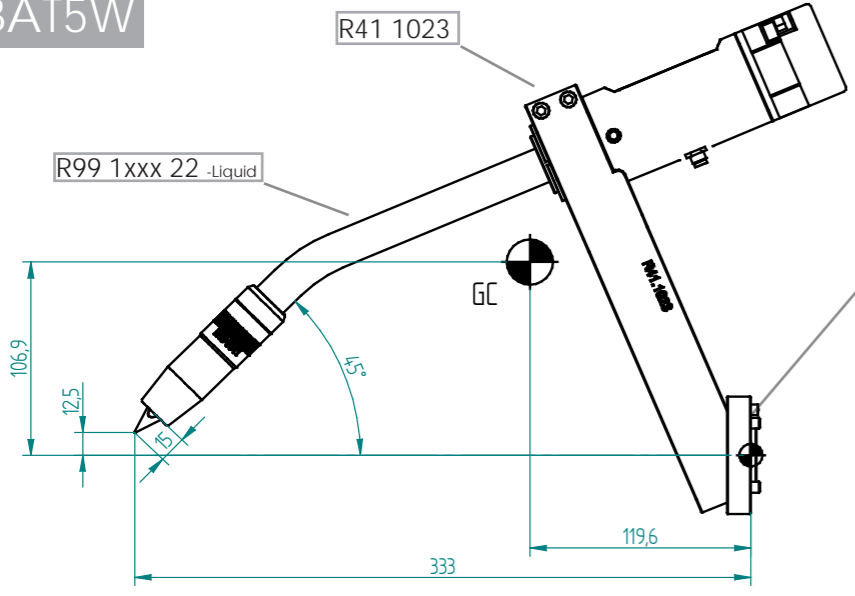

DATA	
Weight (kg)	1.44
TCP mm (tool center point)	Y:12.5 / Z:333
GC mm (gravity center)	Y:106.9 / Z:119.6

### BAT6W

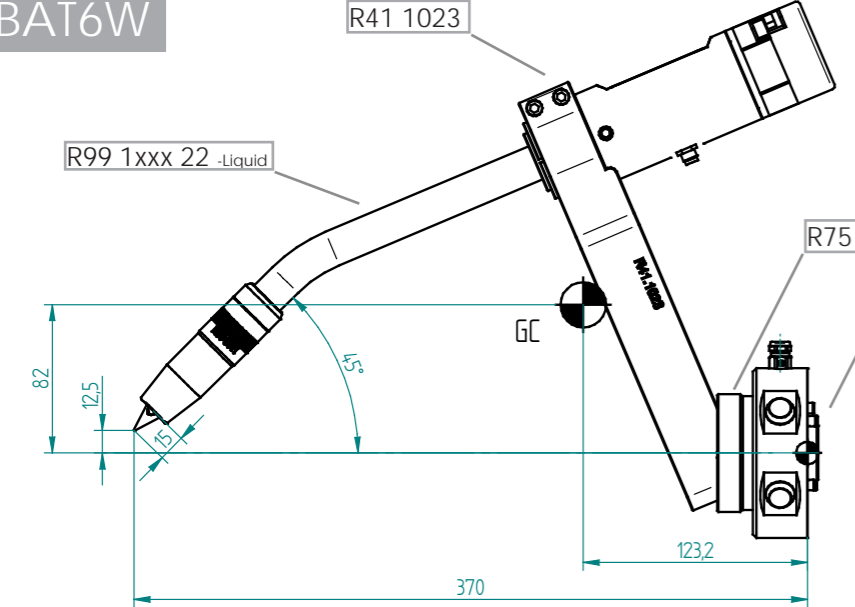

DATA	
Weight (kg)	1.89
TCP mm (tool center point)	Y:12.5 / Z:370
GC mm (gravity center)	Y:82 / Z:123.2

### BAT7W

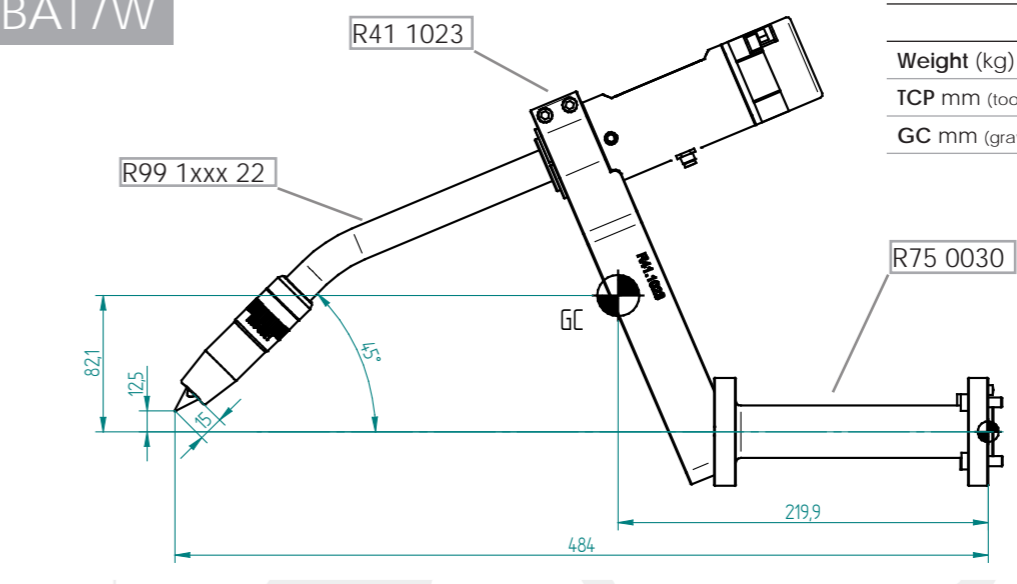

DATA	
Weight (kg)	1.88
TCP mm (tool center point)	Y:12.5, Z:484
GC mm (gravity center)	Y:82.1 / Z:219.9

### BAT8W

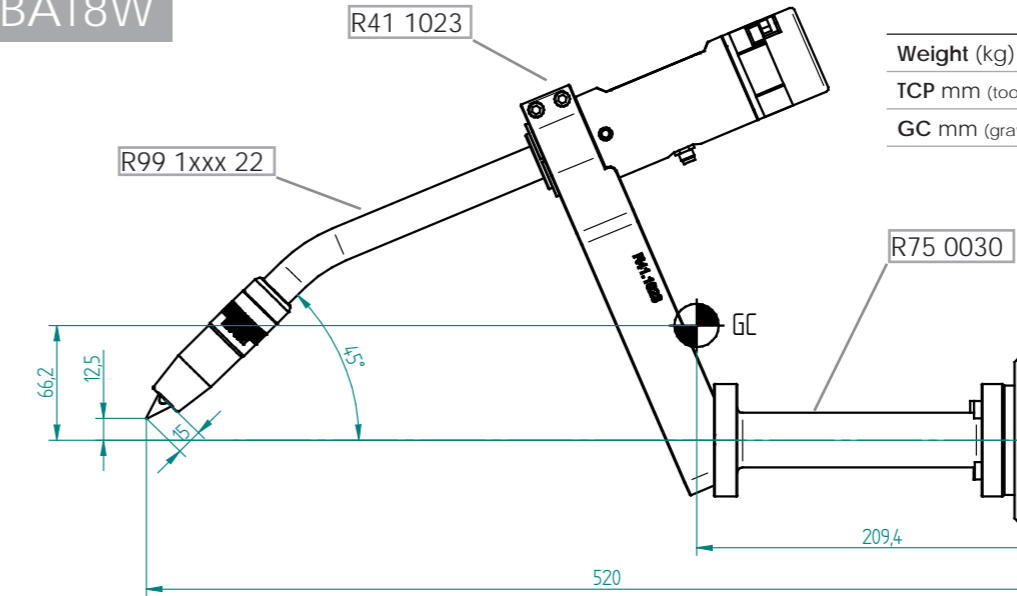

DATA	
Weight (kg)	2.34
TCP mm (tool center point)	Y:12.5, Z:520
GC mm (gravity center)	Y:66.2 / Z:209.4

### BAT9W

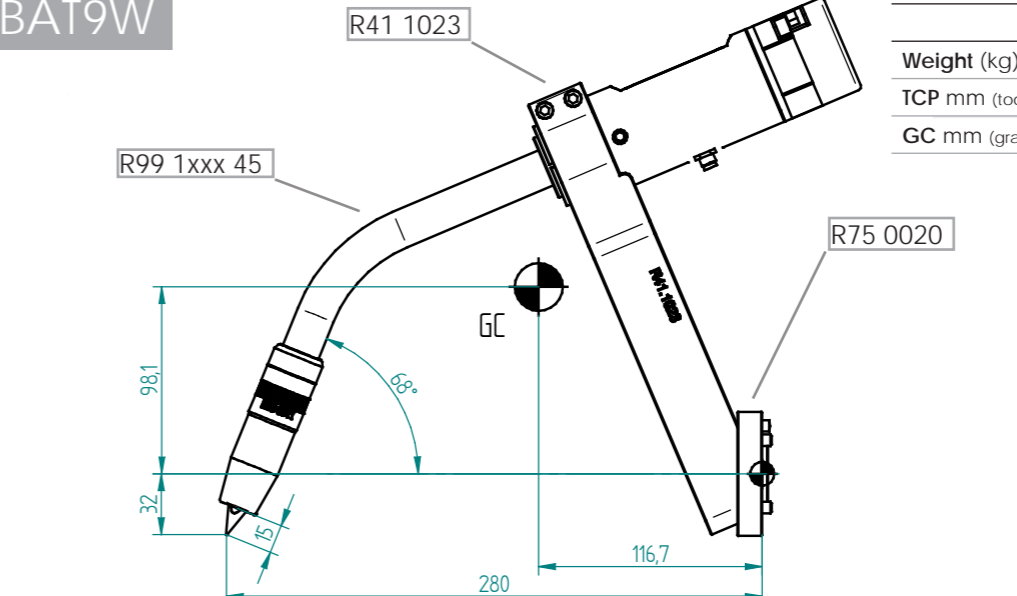

DATA	
Weight (kg)	1.44
TCP mm (tool center point)	Y:-32 / Z:280
GC mm (gravity center)	Y:98.1 / Z:116.7



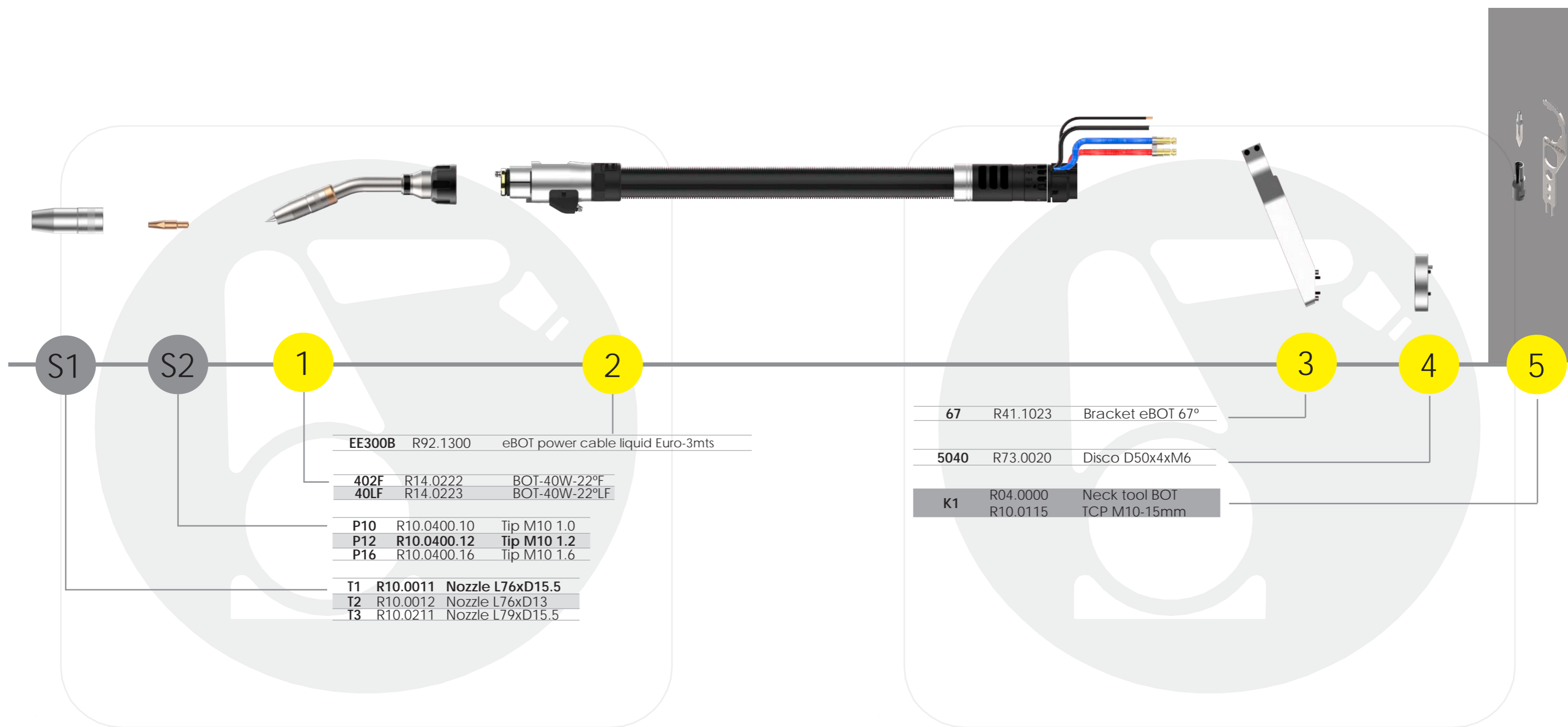

Check the BOT series catalog for more information

Installation code: T1-P10-402F-EE300-67-5040-K1

# BOT 40W series MIG/MAG

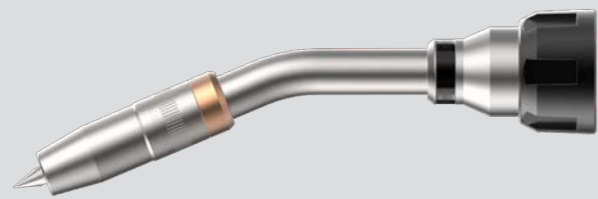

The capacity will be reduced by 35% with pulsed arc.



**Welding process:**  
MIG/MAG, GMAW, 131,135  
Technical data according to IEC60974-7



Liquid



500 A - CO2 100%



400 A - Mix M21 (ISO 14175) 100%



## CONFIGURATIONS

### BOT1W

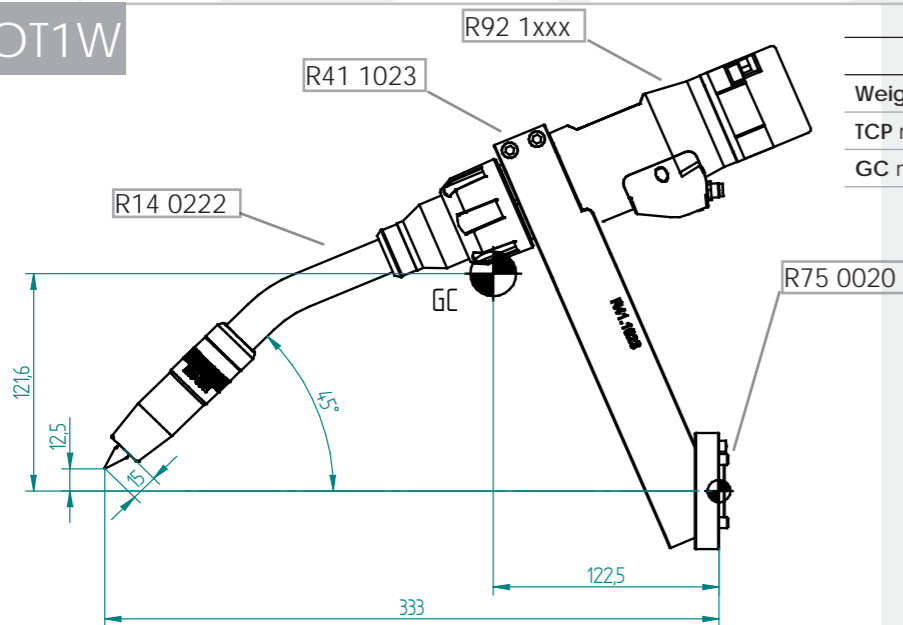

DATA	
Weight (kg)	2.10
TCP mm (tool center point)	Y:12.5, Z:333
GC mm (gravity center)	Y:121.6 / Z:122.5

### BOT2W

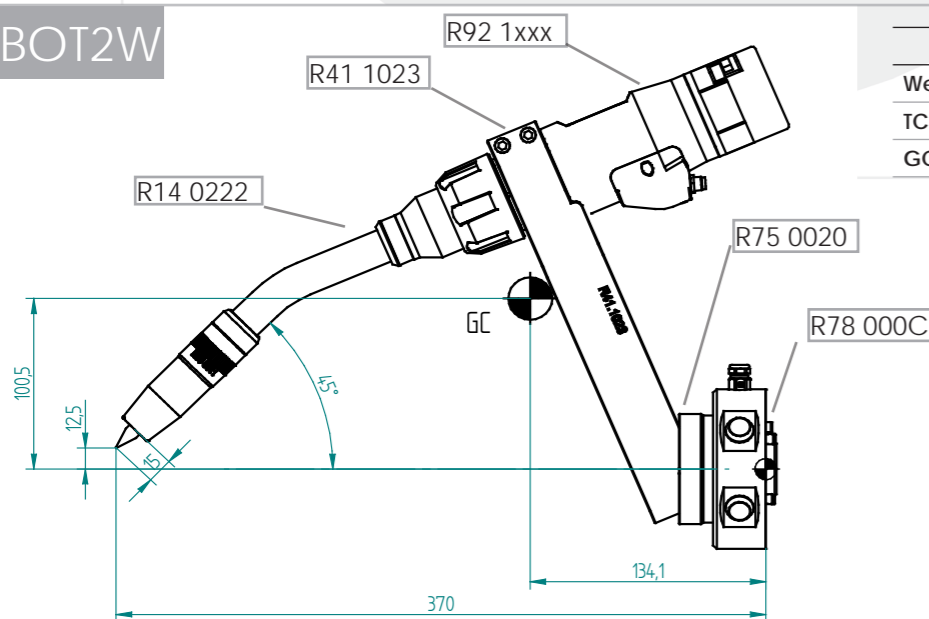

DATA	
Weight (kg)	2.54
TCP mm (tool center point)	Y:12.5, Z:520
GC mm (gravity center)	Y:100.5 / Z:134.1

### BOT3W

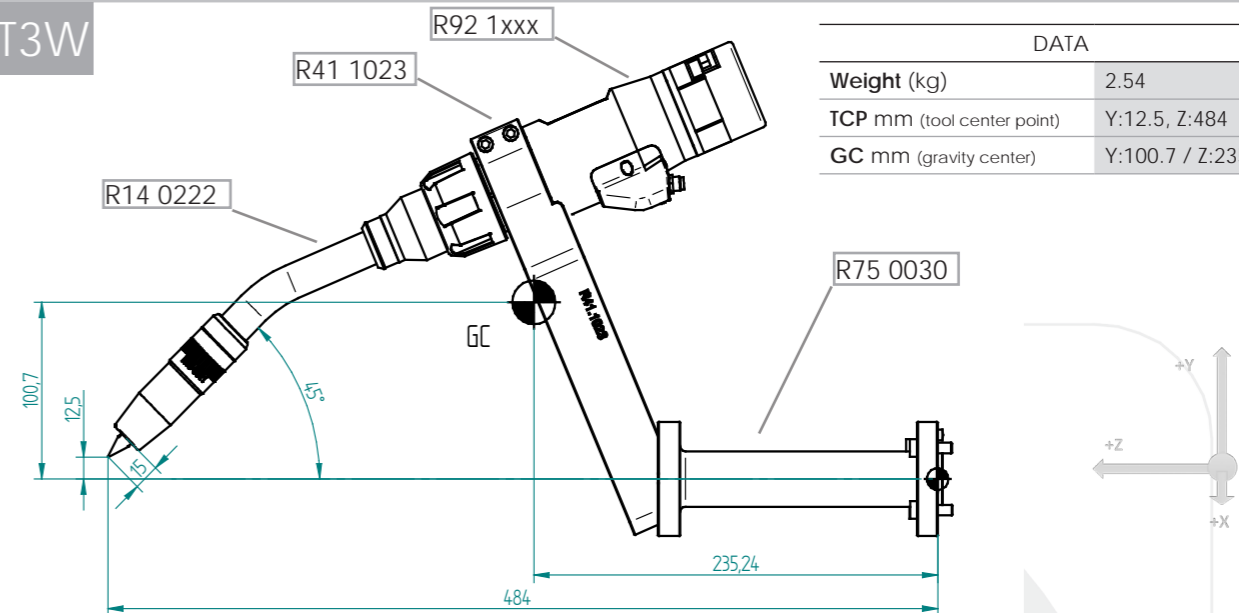

DATA	
Weight (kg)	2.54
TCP mm (tool center point)	Y:12.5, Z:484
GC mm (gravity center)	Y:100.7 / Z:235.24

### BOT4W

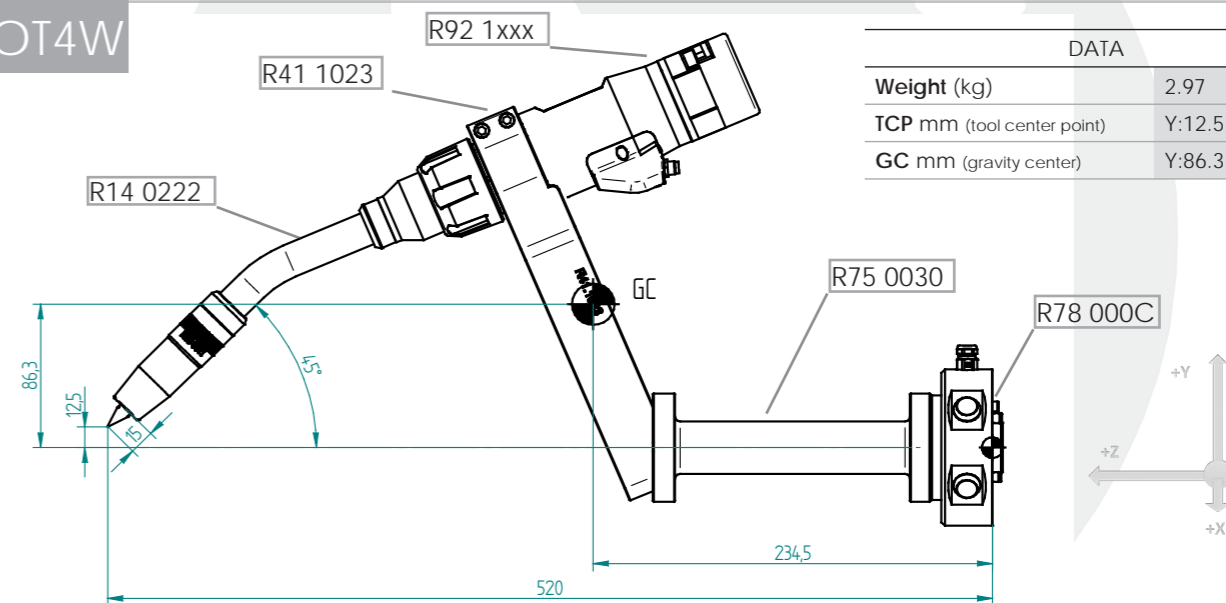

DATA	
Weight (kg)	2.97
TCP mm (tool center point)	Y:12.5, Z:520
GC mm (gravity center)	Y:86.3 / Z:234.5

### BOT5W

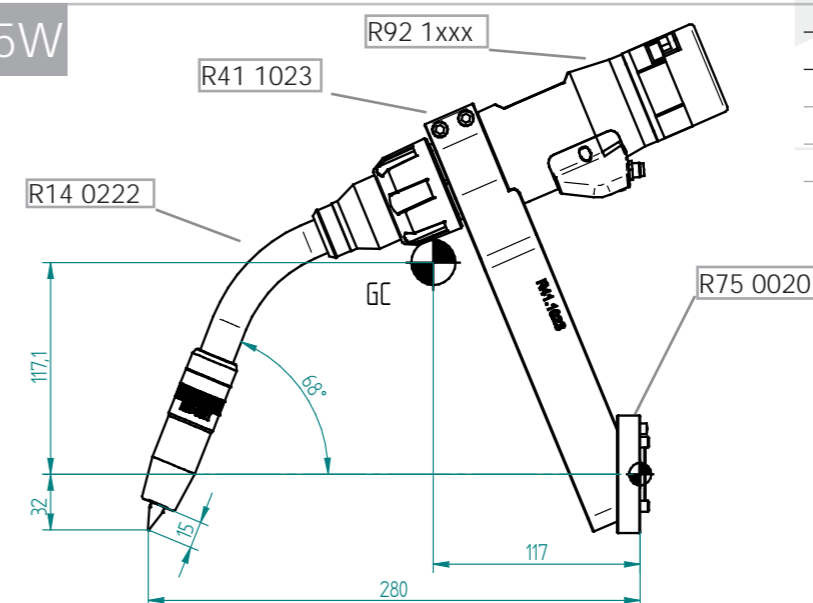

DATA	
Weight (kg)	2.10
TCP mm (tool center point)	Y:-32 / Z:280
GC mm (gravity center)	Y:117.1 / Z:117



Robotic welding torches

Collaborative robots



EDRtorches, S.L.

Calle Miguel Angel Blanco 28. 46138

Rafelbuñol - Valencia Spain.

[www.edrtorches.com](http://www.edrtorches.com)

[info@edrtorches.com](mailto:info@edrtorches.com)

Tel. 0034 963 558 893